



We hope you have had a relaxing half term break and feel refreshed and ready for the new term. We have lots of interesting and exciting learning opportunities this half term. We are thrilled to have been chosen to attend Young Voices in January 2024 so we will be working hard to learn the songs and dance moves we need to be part of the 'largest children's choir in the world!' Please do not hesitate to contact the school if you have any questions. Miss Blogg and Mrs Pickles.

ENGLISH

In English, we are going to be looking at a new text 'Ice Palace' by Robert Swindells. We will be practicing using figurative language in a setting description and using speech and different sentence lengths when writing an alternative ending. We will then finish the term looking at winter poetry and exploring poetic devices.



MATHS



This term Year 4 will be exploring number through multiplication and division and the commutative law – for example $3 \times 4 = 4 \times 3$. We will continue to learn and revise the times tables to 12×12 in preparation for our multiplication check in June. Through perimeter and area, we will learn to apply our mathematical knowledge and continue to explain our reasoning behind our choices.

SCIENCE



In Science, we will explore Sound this term. We will investigate how we hear, and how sounds are made. We will explore patterns between the pitch of a sound on the object and the volume of a sound and the strength of vibrations and how sounds get fainter as the distance increase.

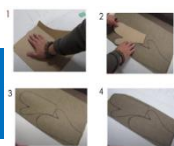

DT

This half term, our Design and Technology task is to design and make an item of clothing. Our challenge is to create a pair of mittens suitable for a trip to the Arctic or Antarctica. We will research existing projects, then design our own product, choose suitable materials, make a pattern, sew materials together and then evaluate our final product.

HISTORY AND GEOGRAPHY

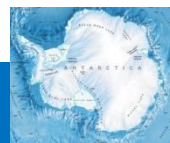

This term, we will continue our learning of the Romans. We will be exploring the legacy the Romans left behind and the reasons why the empire declined. In geography, we will discuss some of the most famous expeditions to the Arctic and Antarctica and begin to consider how humans can affect these Polar regions.

CLASS



Lambeth Class

PE: Tuesday and Friday
Forest school on alternate Mondays.
Week commencing 6th November.

Kew Class

PE: Wednesday and Friday
Forest School on alternate Mondays.
Week commencing 30th October.
Home learning will be sent home every Friday alongside reading records to be completed. There will be daily reading and times tables practise, and the spellings will be updated each week on google classroom.
Please remember to send your child to school with a labelled water bottle each day. As it begins to get colder, please ensure your child has a coat in school. Please label all items belonging to your child.
Please also to continue to practise the songs for Young Voices which is in January.

TRIPS/ DATES

School photos: **2nd November**

Roman workshop with the Mithraeum Museum. In school: **13th November.**